

HEAVY DUTY BOX TRUSSING - SPIGOTED

20.5"x30"

HD BOX SPIGOTED FEATURES

1.9" OD 6061-T6 Aluminum Tube Schd #80
 1.375" OD Aluminum Bracing
 .200" Wall Thickness
 Steel Spigots
 Steel Pins
 Highly Polished Aluminum Tubing
Custom Lengths & Corners Available

HD BOX SPIGOTED CORNER ADAPTERS

2-Way Corner Block
 4-Way Corner Block
 5-Way Corner Block
 45 Degree Corner
 Hinged Corner

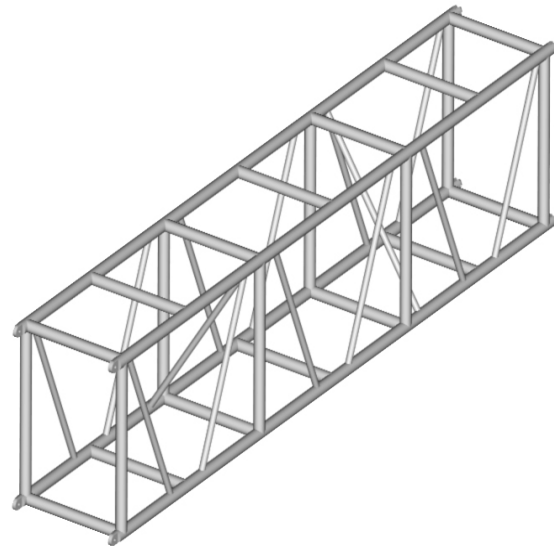

20.5x30 HD BOX SPIGOTED ORDERING INFO

Part Number	Dimensions	Weight
13-08-120	20.5" x 30" x 10'	85 lbs.
13-08-096	20.5" x 30" x 8'	75 lbs.
13-08-060	20.5" x 30" x 5'	50 lbs.

20.5x30 HD BOX SPIGOTED WEIGHT LOADING INFO

Length	10' Span	20' Span	30' Span	40' Span
Uniform Distribution	18000 lbs.	14800 lbs.	11700 lbs.	8240 lbs.
Center Point Load	3760 lbs.	10400 lbs.	3500 lbs.	5400 lbs.

SINGLE HUNG PRT/CLUB TRUSSING - SPIGOTED

15"x23.5" and 15"x30"

SH PRT/CLUB TRUSS FEATURES

1.9" OD 6061-T6 Aluminum Tube Schd #80
 1.05" OD Aluminum Bracing
 Ready to accept Pre-Wired Lampbar With Par 64's
 .200" Wall Thickness
 Steel Spigots
 Steel Pins
 Highly Polished Aluminum Tubing
Custom Lengths & Corners Available

LAMP BARS AND CASTERS SOLD SEPARATELY

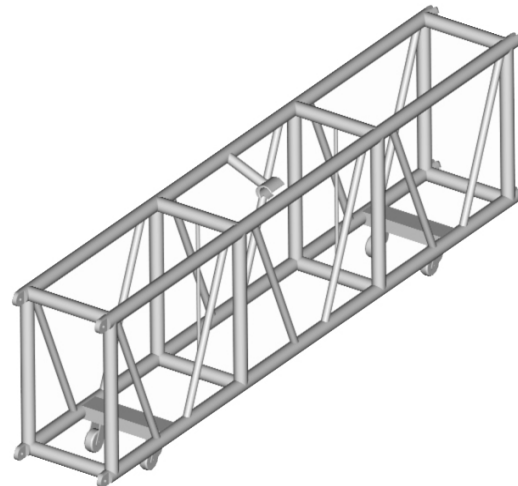

15"x23.5" SPIGOTED SH PRT/CLUB TRUSS INFO

Part Number	Dimensions	Weight
13-02-123	15" x 23.5" x 123"	72 lbs.
13-02-096	15" x 23.5" x 96"	62 lbs.

15"x23.5" SPIGOTED SH PRT/CLUB TRUSS WEIGHT LOADING INFO

Length	10' Span	20' Span	30' Span	40' Span
Uniform Distribution	8600 lbs.	7900 lbs.	6600 lbs.	4400 lbs.
Center Point Load	8600 lbs.	7800 lbs.	5900 lbs.	3400 lbs.

15"x30" SPIGOTED SH PRT/CLUB TRUSS INFO

Part Number	Dimensions	Weight
13-01-123	15" x 30" x 123"	82 lbs.
13-01-096	15" x 30" x 96"	72 lbs.

15"x30" SPIGOTED SH PRT/CLUB TRUSS WEIGHT LOADING INFO

Length	10' Span	20' Span	30' Span	40' Span
Uniform Distribution	8600 lbs.	7900 lbs.	6600 lbs.	4400 lbs.
Center Point Load	8600 lbs.	7800 lbs.	5900 lbs.	3400 lbs.