

HEAVY DUTY BOX TRUSSING

12"x18", 12"x18" Ballroom, 20.5"x20.5" and 20.5"x30"

HEAVY DUTY BOX TRUSS FEATURES

- 1.9" OD 6061-T6 Aluminum Tube Schd #40
- 1.05" OD Aluminum Bracing
- .145" Wall Thickness
- Highly Polished Aluminum Tubing
- Custom Lengths & Corners Available

HEAVY DUTY BOX TRUSS CORNER ADAPTERS

- 2-Way Corner Block
- 4-Way Corner Block
- 5-Way Corner Block
- 45 Degree Corner
- Hinged Corner

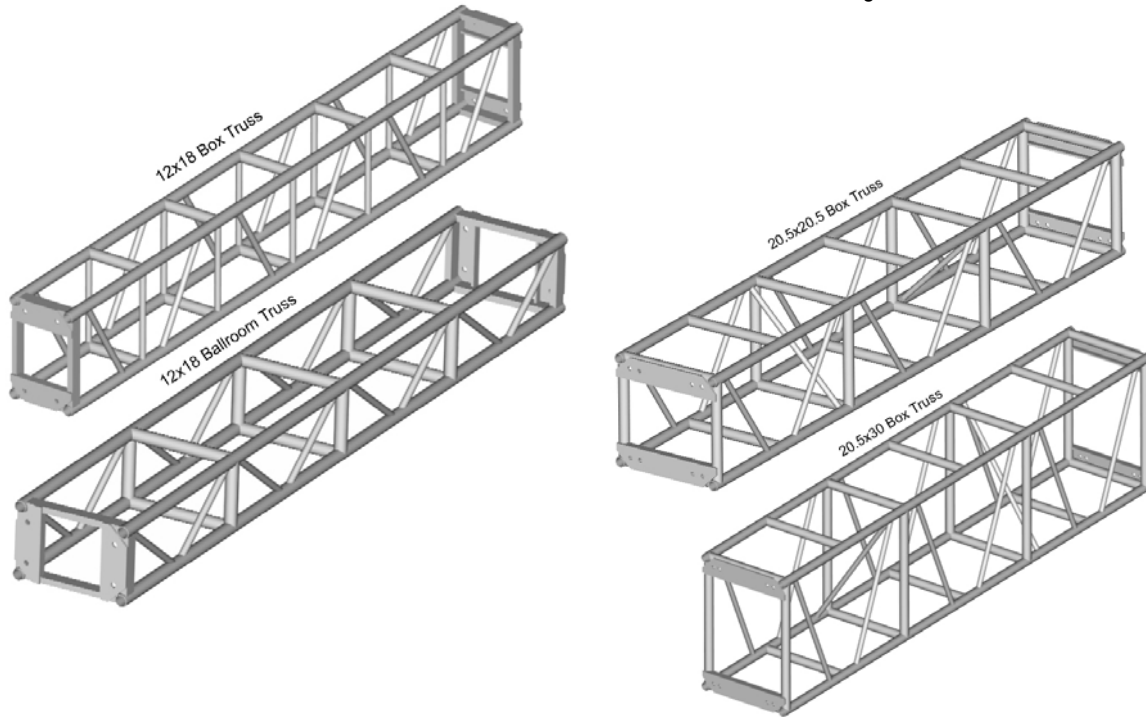

12"x18" HD BOX TRUSS INFO

Part Number	Dimensions	Weight
9-01-120	12" x 18" x 10'	70 lbs.
9-01-096	12" x 18" x 8'	58 lbs.
9-01-060	12" x 18" x 5'	45 lbs.

12"x18" HD BOX TRUSS WEIGHT LOADING INFO

Length	10' Span	20' Span	30' Span	40' Span
Uniform Distribution	4200 lbs.	2600 lbs.	1700 lbs.	850 lbs.
Center Point Load	3100 lbs.	1600 lbs.	900 lbs.	600 lbs.

12"x18" BALLROOM TRUSS INFO

Part Number	Dimensions	Weight
9-04-120	12" x 18" x 10'	70 lbs.
9-04-060	12" x 18" x 5'	45 lbs.

12"x18" BALLROOM TRUSS WEIGHT LOADING INFO

Length	10' Span	20' Span	30' Span	40' Span
Uniform Distribution	5300 lbs.	3840 lbs.	2880 lbs.	2400 lbs.
Center Point Load	2920 lbs.	2840 lbs.	1920 lbs.	1760 lbs.

*Weight Load Certified By Structural Engineering Firm

20.5"x20.5" HD BOX TRUSS INFO

Part Number	Dimensions	Weight
9-02-120	20.5" x 20.5" x 10'	90 lbs.
9-02-096	20.5" x 20.5" x 8'	80 lbs.

20.5"x20.5" HD BOX TRUSS WEIGHT LOADING INFO

Length	10' Span	20' Span	30' Span	40' Span
Uniform Distribution	8000 lbs.	7000 lbs.	3360 lbs.	2000 lbs.
Center Point Load	7000 lbs.	4310 lbs.	2045 lbs.	1150 lbs.

*Weight Load Certified By Structural Engineering Firm

NOTE: 20.5" x 30" HD Box Truss Has 1.375" OD Alum Bracing

20.5"x30" HD BOX TRUSS INFO

Part Number	Dimensions	Weight
9-03-120	20.5" x 30" x 10'	90 lbs.
9-03-096	20.5" x 30" x 8'	80 lbs.
9-03-060	20.5" x 30" x 5'	70 lbs.

20.5"x30" HD BOX TRUSS WEIGHT LOADING INFO

Length	10' Span	20' Span	30' Span	40' Span	50' Span
Uniform Distribution	20000 lbs.	14000 lbs.	9500 lbs.	8000 lbs.	6000 lbs.
Center Point Load	15000 lbs.	7500 lbs.	5000 lbs.	3800 lbs.	3100 lbs.

*Weight Load Certified By Structural Engineering Firm