

EURO STYLE BOX TRUSSING

Available in 12"x12" and 16"x16"

EURO STYLE BOX TRUSS FEATURES

- 1.9" OD 6061-T6 Aluminum Tube Schd #40
- 1/2" Solid Aluminum Rod Bracing
- .145" Wall Thickness
- 1-3/4" x 1/4" Aluminum End Plates
- Highly Polished Aluminum Tubing
- Custom Lengths & Corners Available

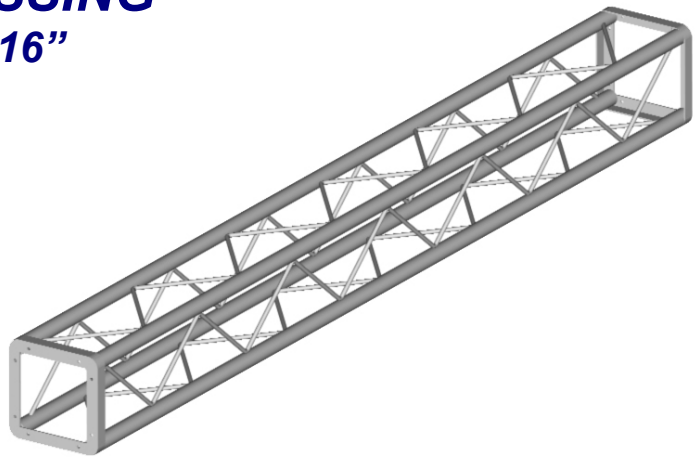

EURO STYLE BOX TRUSS CORNER ADAPTERS

- 6-Way Corner Block
- 45 Degree Corner
- Hinged Corner

12"x12" EURO BOX TRUSS INFO

Part Number	Dimensions	Weight
8-12-120	12" x 12" x 10'	51 lbs.
8-12-096	12" x 12" x 8'	32 lbs.
8-12-060	12" x 12" x 5'	23 lbs.
8-12-030	12" x 12" x 2.5'	13 lbs.

12"x12" EURO BOX TRUSS WEIGHT LOADING INFO

Length	10' Span	20' Span	30' Span	40' Span
Uniform Distribution	2800 lbs.	2600 lbs.	1400 lbs.	700 lbs.
Center Point Load	2100 lbs.	1600 lbs.	700 lbs.	450 lbs.

16"x16" EURO BOX TRUSS INFO

Part Number	Dimensions	Weight
8-16-120	16" x 16" x 10'	51 lbs.
8-16-096	16" x 16" x 8'	42 lbs.
8-16-060	16" x 16" x 5'	33 lbs.
8-16-030	16" x 16" x 2.5'	22 lbs.

16"x16" EURO BOX TRUSS WEIGHT LOADING INFO

Length	10' Span	20' Span	30' Span	40' Span
Uniform Distribution	3000 lbs.	2800 lbs.	1600 lbs.	900 lbs.
Center Point Load	2300 lbs.	1800 lbs.	750 lbs.	500 lbs.

ALL PURPOSE BOX TRUSSING

Available in 12"x12"

ALL PURPOSE BOX TRUSS FEATURES

- 1.9" OD 6061-T6 Aluminum Tube Schd #40
- 1.05" OD Aluminum Bracing
- .145" Wall Thickness
- Highly Polished Aluminum Tubing
- Custom Lengths & Corners Available

ALL PURPOSE BOX TRUSS CORNER ADAPTERS

- 5-Way Corner Block
- 45 Degree Corner
- Hinged Corner

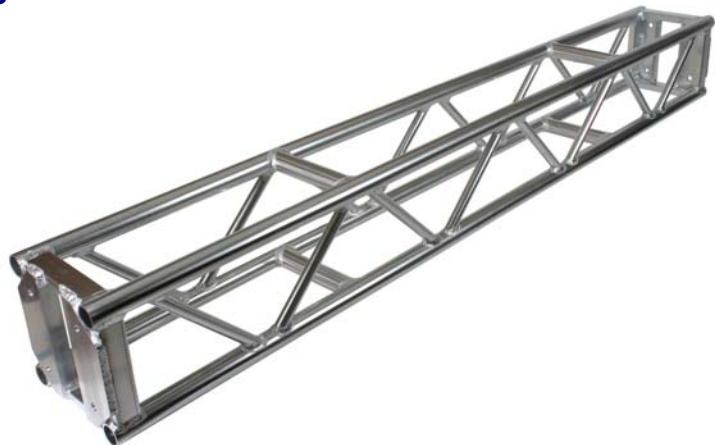

12"x12" ALL PURPOSE BOX TRUSS INFO

Part Number	Dimensions	Weight
11-12-120	12" x 12" x 10'	55 lbs.
11-12-096	12" x 12" x 8'	46 lbs.
11-12-060	12" x 12" x 5'	35 lbs.
11-12-030	12" x 12" x 2.5'	24 lbs.

12"x12" ALL PURPOSE BOX TRUSS WEIGHT LOADING INFO

REVISION IN PROGRESS